

Recorded This 15th day of April, 2002
 in the Public Records of Martin County
 Florida in Plat Book 15 page 23
 File: 1565429
 MARSHA Ewing Clerk Circuit Court
 by Charlotte Curkey DC

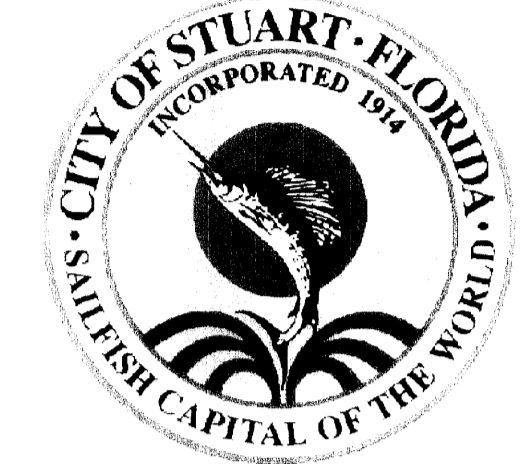

CITY OF STUART NO.	SHEET NO.
	1

CITY OF STUART



MAINTENANCE MAP OF PORTIONS OF OSCEOLA STREET, SEMINOLE STREET, COLORADO AVENUE AND ST. LUCIE AVENUE

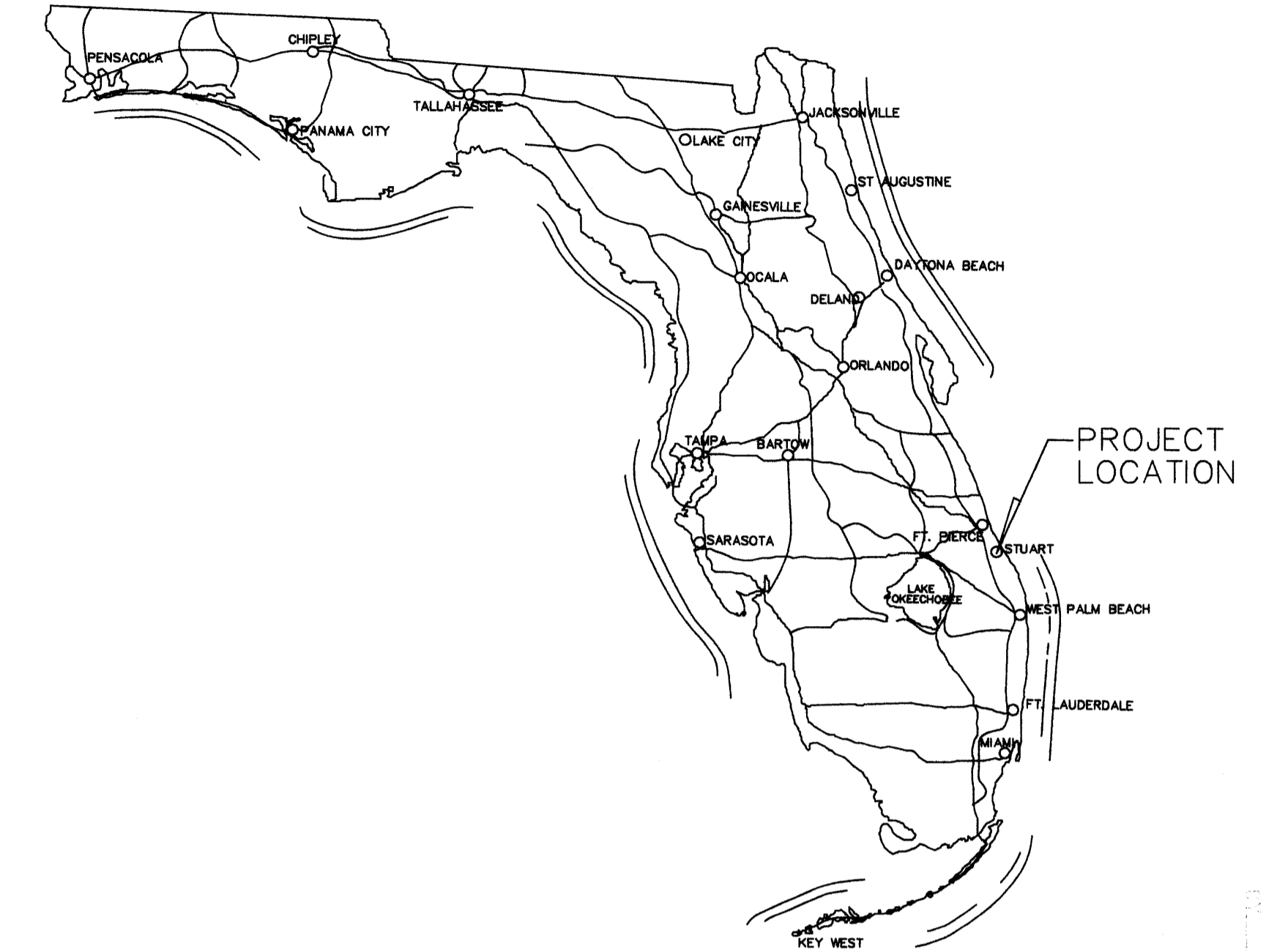

ENGINEER'S CERTIFICATE

THIS IS TO CERTIFY THAT THE RIGHT OF WAY LIMITS AS SHOWN ON THIS MAP WERE IDENTIFIED BY MYSELF AS HAVING BEEN MAINTAINED CONTINUOUSLY FOR FOUR (4) YEARS WITHOUT INTERRUPTION.

BY: Samuel P. ...
 MAINTENANCE ENGINEER

CITY OF STUART CERTIFICATION

THIS IS TO CERTIFY THAT THE WITHIN AND ATTACHED SHEETS NUMBERED 1 TO 5, INCLUSIVE CONSTITUTE A TRUE COPY OF THE OFFICIAL MAINTENANCE MAP SHOWING LOCATION AND SURVEY BY BETSY LINDSAY, INC. FOR A PORTION OF OSCEOLA AVE., FLAGLER DR., SEMINOLE ST., COLORADO AVE., & ST. LUCIE ST., LOCATED IN CITY OF STUART, MARTIN COUNTY, FLORIDA.

THE PROPERTY LABELED MAINT. R/W ON SAID SHEETS HAS BEEN VESTED IN THE CITY OF STUART, PURSUANT TO THE PROVISION OF SECTION 95.361, FLORIDA STATUTES.

IN WITNESS WHEREOF, WE HAVE HEREUNTO SET OUR HANDS AND AFFIXED THE SEAL OF MARTIN COUNTY, FLORIDA THIS 9th DAY OF APRIL, A.D. 2002.

BY: Charles S. Foster MAYOR
DiAnne A. O'Donnell CLERK
 BOARD OF CITY OF STUART COMMISSIONERS
 MARTIN COUNTY, FLORIDA

FILED FOR RECORD IN THE OFFICE OF THE CLERK OF THE CIRCUIT COURT FOR COUNTY OF MARTIN, STATE OF FLORIDA, IN PLAT BOOK _____ AT PAGE _____ ON THE _____ DAY OF _____, A.D. 2002.

BY: _____
 CLERK OF THE CIRCUIT COURT
 MARTIN COUNTY, FLORIDA

SURVEYOR'S NOTES

1. THIS IS NOT A SURVEY.
2. BEARINGS SHOWN HEREON ARE BASED ON STATE PLANE COORDINATES, NATIONAL AMERICAN DATUM 83/90 ADJUSTED, FLORIDA EAST ZONE, REFERENCE A BEARING OF N89°46'34"E ON THE BASELINE OF OSCEOLA AVE.
3. PROPERTY BOUNDARIES DETERMINED FROM FIELD SURVEYS, RECORD TITLE AND RECORDED PLATS.
4. UNDERGROUND FOUNDATION ENCROACHMENTS WERE NOT LOCATED.
5. ALL PLATS REFERENCED HEREON ARE MARTIN COUNTY PLATS, UNLESS OTHERWISE NOTED.
6. EXISTING RIGHT-OF-WAY LINES AS SHOWN HEREON ARE BASED ON RECORD PLAT DATA. NO TITLE SEARCH WAS FURNISHED.
7. DISTANCES SHOWN ARE GROUND DISTANCES.

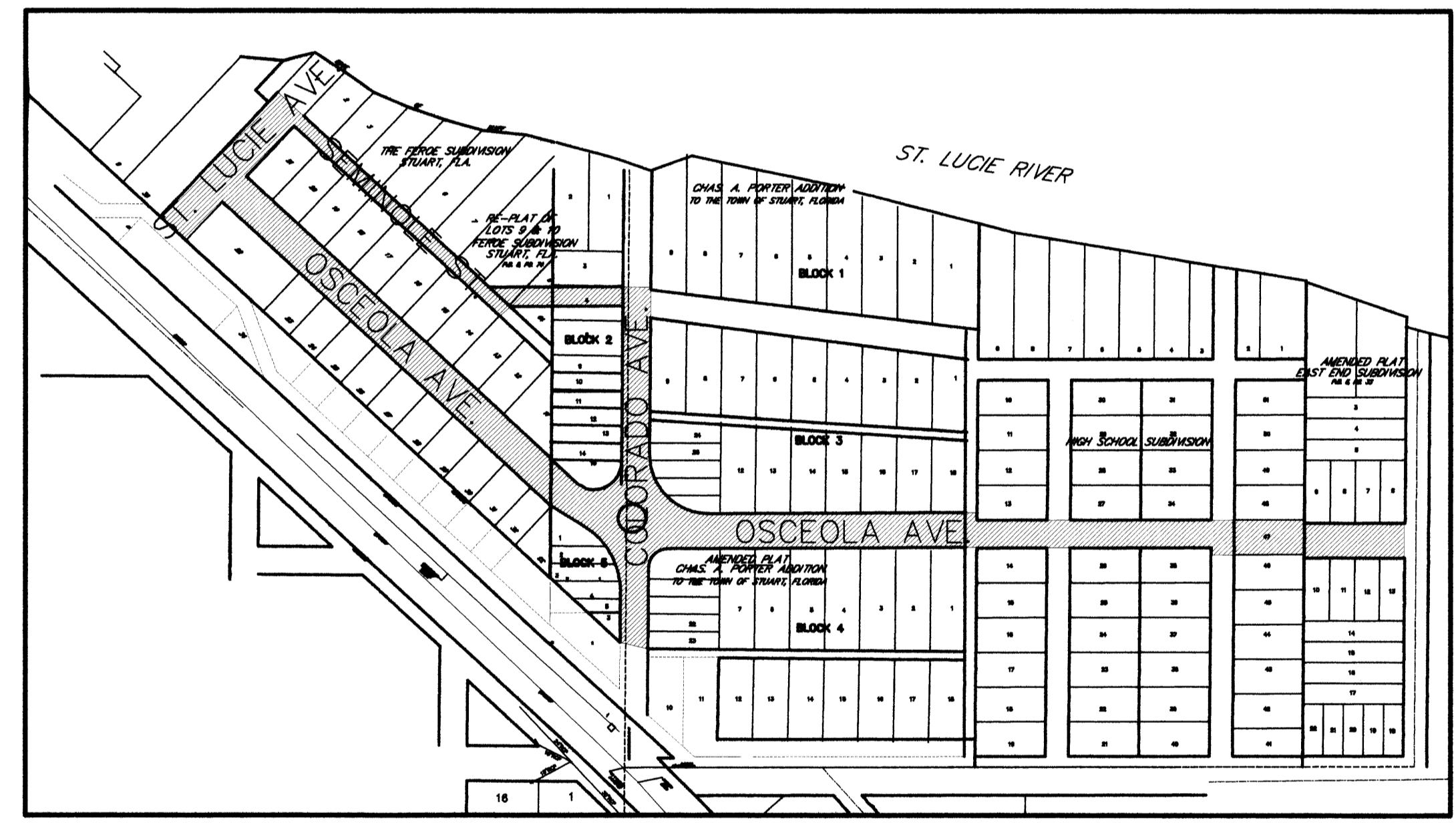

LOCATION MAP
 (NOT TO SCALE)

LEGEND

- PROPERTY ACQUIRED THROUGH THIS MAINTENANCE MAP
- PROPERTY LINE
- RIGHT-OF-WAY
- RIGHT-OF-WAY LINE REPLACED BY THE MAINTAINED RIGHT OF WAY
- MAINTAINED RIGHT-OF-WAY
- NAIL AND TIN TAB
- PARKER KALON NAIL & TIN TAB
- SCRIBE
- DRILL HOLE
- IRON ROD
- CONCRETE MONUMENT
- PARKER-KALON NAIL & WASHER
- WATER VALVE
- GATE VALVE
- TELEPHONE MANHOLE
- SANITARY MANHOLE
- DRAINAGE MANHOLE
- LIGHT POLE
- SIGN
- SPRINKLER

ABBREVIATIONS

- P.B. DENOTES PLAT BOOK
- PG. DENOTES PAGE
- SEC. DENOTES SECTION
- TWP. DENOTES TOWNSHIP
- RGE. DENOTES RANGE
- MAINT. DENOTES MAINTAINED
- R/W DENOTES RIGHT-OF-WAY
- FEC DENOTES FLORIDA EAST COAST
- RR DENOTES RAILROAD
- STA. DENOTES STATION
- R DENOTES RIGHT
- L DENOTES LEFT
- FND. DENOTES FOUND
- IP DENOTES IRON PIPE
- ODIP DENOTES OUTSIDE DIAMETER IRON PIPE
- PK&W DENOTES PARKER KALON NAIL & WASHER
- PK&T DENOTES PARKER KALON NAIL & TIN TAB
- N&T DENOTES NAIL & TIN TAB
- RLS DENOTES REGISTERED LICENSED SURVEYOR
- PSM DENOTES PROFESSIONAL SURVEYOR & MAPPER
- PLS DENOTES PROFESSIONAL LICENSED SURVEYOR
- LB DENOTES LICENSED BUSINESS
- CONC. DENOTES CONCRETE
- C & G DENOTES CONCRETE CURB AND GUTTER
- DWG. DENOTES DRAWING
- NO. DENOTES NUMBER

PLANS PREPARED BY:

B BETSY LINDSAY, INC.
 SURVEYING AND MAPPING
 208 N. US 1, # 8 TEQUESTA, FLORIDA 33469
 (561)575-5275 (561)575-4324 FAX

SURVEYOR'S CERTIFICATE

THIS SURVEY WAS PERFORMED FOR THE SPECIFIC PURPOSE OF LOCATING THE LIMITS OF MAINTAINED RIGHT OF WAY AS IDENTIFIED BY THE MAINTENANCE ENGINEER FOR CITY OF STUART. I HEREBY CERTIFY THAT TO THE BEST OF MY PROFESSIONAL KNOWLEDGE AND BELIEF THIS IS A TRUE, ACCURATE AND COMPLETE DEPICTION OF A FIELD SURVEY PERFORMED UNDER MY DIRECTION AND COMPLETED IN JUNE 14 OF 2001. I FURTHER CERTIFY THAT SAID "SPECIFIC PURPOSE SURVEY" IS IN COMPLIANCE WITH THE MINIMUM TECHNICAL STANDARDS AS SET FORTH BY THE FLORIDA BOARD OF PROFESSIONAL LAND SURVEYORS, PURSUANT TO SECTION 472.027, FLORIDA STATUTES.

BETSY LINDSAY, INC.
 SURVEYING AND MAPPING

BY: Elizabeth A. Lindsay
 ELIZABETH A. LINDSAY, P.L.S.
 FLORIDA REGISTRATION NO. 4724

NOT VALID UNLESS
 SIGNED AND SEALED

DATE: 3/27/02

SPECIFIC PURPOSE SURVEY OSCEOLA AVE.

CITY OF STUART			
ENGINEERING / RIGHT-OF-WAY DIVISION			
MAINTENANCE MAP			
PORTIONS OF OSCEOLA ST., SEMINOLE ST., COLORADO AVE., & ST. LUCIE AVE. MARTIN COUNTY, FLORIDA			
BY	DATE	APPROVED BY:	DATE
W.B./D.B.	4/19/01		
TRACED	N/A		
CHECKED	E.A.L. 4/19/01	MARTIN COUNTY SURVEY AND RIGHT-OF-WAY DEPARTMENT	
MAPS PREPARED BY:		FIELD BOOK NOS.	
BETSY LINDSAY, INC.		STUART 6 / 45-54	
LICENSED BUSINESS NO. 6852		SCALE SCALE AS SHOWN	
REVISION	BY	DATE	SECTION OSCEOLA AVE. SHEET 1 OF 6

REFERENCES

1. RECORDED PLATS
2. DEEDS OF RECORD